

PLAN TOPOGRAFIC

Coridor de expropriere pentru Proiectul:
"Varianta de Dcolire Municipiul Fagaras" - tronson 1.



Scala 1 : 2000



Anexa la PROCES
VERBAL DE
RECEPȚIE nr.
894/2022
privind cererea
3780/16.02.2022

Monica Anda Jigara

Semat digitală de Monica Anda Jigara
Date: 2022.02.28 08:30:06 +02:00

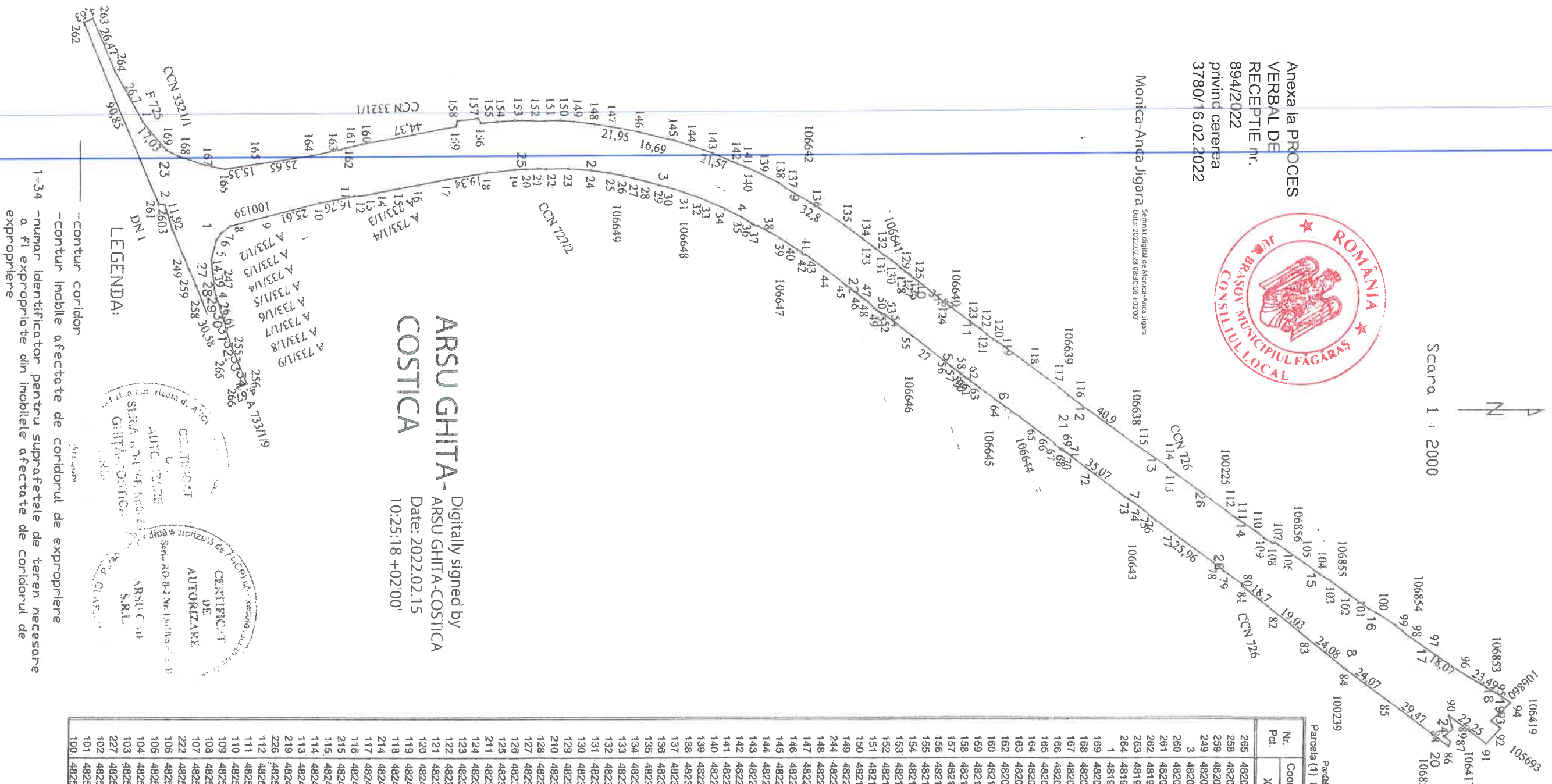

ARSU GHITA - ARSU GHITA-COSTICA
Digitally signed by
Date: 2022.02.15
10:25:18 +02:00

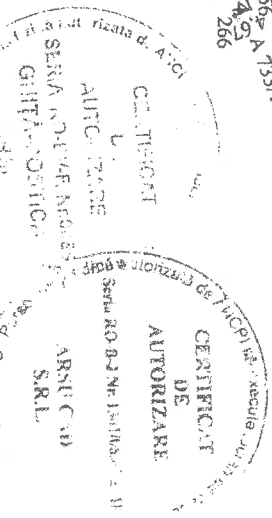

-contur coridor
-contur imobile afectate de coridorul de expropriere
1+34 -numar identificator pentru suprafețele de teren necesare
a fi expropriate din imobilele afectate de coridorul de
expropriere

Parcela (1) tronson centura

Nr. Pct.	Coordonate pct. de contur X [m]	Y [m]	Lungimi latimi D(i,+1)
266	482038.365	495791.312	29.890
258	482026.610	495763.826	7.499
259	482023.663	495756.930	8.435
249	482012.535	495730.885	11.976
3	482009.112	495719.471	2.783
260	482006.338	495719.249	90.855
261	482006.338	495719.249	6.828
262	481971.114	495635.500	26.474
263	481975.364	495633.669	26.701
264	481985.837	495657.983	26.701
1	481998.727	495681.386	17.028
189	482009.685	495694.400	0.224
168	482015.237	495703.237	12.989
167	482027.580	495701.319	9.903
166	482037.276	495703.237	15.363
165	482052.452	495700.916	25.649
164	482077.839	495697.261	14.865
163	482092.374	495694.144	2.040
162	482094.295	495693.456	44.366
160	482102.266	495691.740	8.154
159	482145.872	495683.566	2.728
158	482146.577	495680.931	9.922
157	482156.442	495679.871	2.548
156	482157.707	495682.083	1.872
155	482159.572	495681.917	6.364
154	482165.741	495681.438	8.369
153	482174.092	495680.974	8.369
152	482182.459	495680.776	7.321
151	482189.780	495680.801	6.277
150	482196.055	495680.967	6.359
149	482202.399	495681.406	9.234
244	482211.572	495682.466	0.178
148	482211.749	495682.467	8.367
147	482220.023	495683.730	13.582
146	482223.365	495686.274	18.690
145	482249.581	495690.223	9.382
144	482258.580	495692.878	10.501
143	482288.529	495696.237	12.478
142	482280.111	495700.881	4.063
141	482283.930	495702.267	2.211
140	482285.988	495703.075	5.329
139	482290.862	495705.230	10.495
138	482300.172	495710.074	3.272
137	482302.834	495711.977	13.233
136	482314.302	495718.579	19.576
135	482330.874	495728.999	11.217
134	482340.069	495735.424	7.084
133	482345.803	495739.583	5.031
132	482348.861	495742.597	2.916
131	482352.277	495744.190	2.078
130	482354.013	495745.328	5.358
129	482358.223	495748.642	0.699
128	482360.268	495750.293	2.201
210	482368.768	495749.076	1.932
210	482368.768	495749.076	1.932
212	482368.838	495773.925	4.041
121	482369.838	495776.847	16.919
122	482396.882	495779.536	2.017
120	482402.804	495781.795	18.140
119	482404.583	495782.746	7.749
118	482419.218	495793.468	11.296
214	482425.470	495798.041	1.926
117	482434.587	495804.710	5.006
116	482438.461	495807.880	31.981
215	482464.393	495826.596	8.922
115	482471.628	495831.817	16.227
114	482485.000	495841.009	2.847
106	482541.864	495881.479	10.040
105	482550.105	495887.213	8.929
104	482557.304	495892.486	6.118
103	482562.513	495895.704	6.504
227	482567.730	495899.588	2.493
102	482569.730	495901.077	13.524
101	482580.755	495908.938	3.444
100	482583.816	495910.477	1.530

230	482585.079	495911.340	9.554
99	482592.968	495916.729	8.069
98	482598.126	495921.943	11.814
97	482608.817	495928.700	18.066
96	482623.713	495938.921	11.100
235	482633.212	495944.664	11.871
236	482643.371	495950.805	0.519
94	482647.184	495953.401	4.094
93	482638.057	495962.066	5.820
92	482642.702	495965.572	10.000
91	482636.937	495972.937	22.248
90	482618.188	495959.522	7.008
89	482620.135	495966.254	5.172
88	482616.045	495969.420	4.009
87	482619.159	495971.945	2.509
86	482618.196	495974.262	1.984
237	482616.617	495973.061	5.936
203	482611.892	495969.468	29.443
85	482588.456	495951.645	24.068
84	482569.273	495937.108	24.077
83	482550.515	495922.014	19.028
82	482535.747	495910.016	18.700
81	482521.230	495898.229	1.272
80	482520.939	495896.991	5.772
202	482516.217	495893.672	4.502
79	482512.534	495891.083	4.328
196	482509.148	495888.386	2.714
78	482507.025	495886.695	26.980
77	482486.170	495871.295	11.114
76	482477.313	495864.522	2.910
75	482475.215	495862.506	5.926
74	482470.533	495868.874	5.998
73	482465.474	495865.652	23.103
72	482446.959	495841.833	11.969
71	482437.399	495834.632	1.288
70	482436.344	495833.894	0.617
69	482435.975	495833.400	0.776
68	482435.218	495833.238	3.584
67	482432.331	495831.111	2.689
66	482430.245	495828.998	5.945
65	482425.314	495826.678	18.754
194	482410.270	495814.481	3.187
190	482407.279	495812.580	5.063
64	482403.668	495809.567	14.076
63	482392.349	495801.200	1.815
62	482391.008	495799.977	0.874
61	482390.213	495799.614	1.226
60	482389.192	495798.936	2.183
59	482387.466	495797.600	1.865
58	482386.095	495796.336	1.947
57	482384.434	495795.320	2.071
56	482382.793	495794.056	19.481
191	482381.159	495782.433	7.523
55	482361.122	495777.944	11.990
54	482351.576	495770.788	0.880
53	482350.865	495770.270	0.665
52	482350.272	495769.969	1.187
51	482349.132	495769.640	1.353
50	482348.007	495768.888	3.187
49	482345.410	495767.040	3.971
48	482342.642	495764.193	1.830
47	482341.090	495763.223	2.097
46	482338.374	495762.017	8.930
45	482332.136	495756.786	3.353
188	482329.419	495754.821	9.517
44	482321.767	495749.245	11.375
43	482312.467	495742.609	1.331
42	482311.162	495742.348	1.533
41	482310.216	495741.142	1.506
40	482308.978	495740.284	9.691
48	482307.622	495738.193	1.830
47	482306.622	495735.259	11.366
39	482290.752	495729.746	2.032
38	482288.799	495728.184	1.282
37	482287.728	495728.479	5.566
36	482282.978	495725.577	9.473
35	482274.428	495721.498	9.629
34	482265.489	495717.918	4.677
33	482261.135	495716.210	6.684
32	482254.792	495714.102	2.669
184	482252.248	495713.300	5.017
31	482247.460	495710.584	4.756
29	482242.861	495710.584	3.379
30	482240.854	495707.557	5.752
28	482238.435	495708.854	5.730
27	482230.325	495707.557	5.730
26	482225.299	495706.084	5.689
25	482219.700	495705.057	9.470
24	482210.326	495703.714	10.492
23	482199.860	495702.969	10.510
22	482193.351	495702.848	3.903
21	482185.457	495702.580	1.178
179	482184.285	495702.700	4.300
20	482180.007	495703.138	5.035
253	482174.979	495703.411	1.004
19	482173.976	495703.465	3.401
252	482170.592	495704.808	9.774
18	482160.868	495704.794	19.339
17	482141.789	495707.834	0.589
250	482141.190	495707.940	13.138
16	482128.267	495710.308	8.870
15	482119.551	495714.068	10.907
14	482108.850	495714.986	3.991
13	482104.942	495714.879	3.188
12	482101.812	495715.483	0.682
172	482101.130	495715.500	2.445
11	482098.686	495715.582	16.756
10	482082.243	495718.786	25.605
9	482077.428	495725.099	18.057
8	482073.904	495729.452	5.988
7	482035.264	495732.742	3.562
6	482033.256	495735.708	9.266
5	482030.829	495744.651	0.148
171	482030.846	495744.798	8.783
247	482031.833	495758.949	5.459
4	482030.443	495804.265	26.610
255	482048.433	495802.411	19.752
256	482044.145	495804.265	4.672
266	482044.145	495804.265	14.188

Total suprafața expropriata 18379 mp